

D	=	143TC - 184C Frame, Double Containment Can						X	X		
R	=	1.125 inch Input Shaft, Single Containment Can								X	X
T	=	1.125 inch Input Shaft, Double Containment Can								X	X
STANDARD METRIC MOUNTING											
J	=	71 Frame, Single Containment Can (85.0 mm B.C.)	(4)	X	X						
K	=	80 Frame, Single Containment Can (100.0 mm B.C.)		X	X	X	X				
L	=	90 Frame, Single Containment Can (115.0 mm B.C.)				X	X				
P	=	100 Frame, Single Containment Can (130.0 mm B.C.)						X	X		
Q	=	100 Frame, Double Containment Can (130.0 mm B.C.)						X	X		
U	=	28 mm Input Shaft, Single Containment Can								X	X
V	=	28 mm Input Shaft, Double Containment Can								X	X
Position 9, 10 and 11 Options: Consult your local distributor to meet your special requirements.											

NOTE:

- (1) Maximum differential pressure allowed for plastic/plastic gears is 50 psig
- (2) Pumps with metallic drive and idler gears require minimum viscosity of 100 cPs and are limited to 1440 rpm maximum speed for GMC2-GMH8 pumps and 1150 rpm for GM12-16 pumps.
- (3) Ceramic wear plates with metallic gears require minimum viscosity of 100 cPs.
- (4) For GMC1 pump only: gears, wear plates and bearings are also available with indicated material or RYTON[®]; also available for NEMA 42C, 45C and IEC 63 motor frames

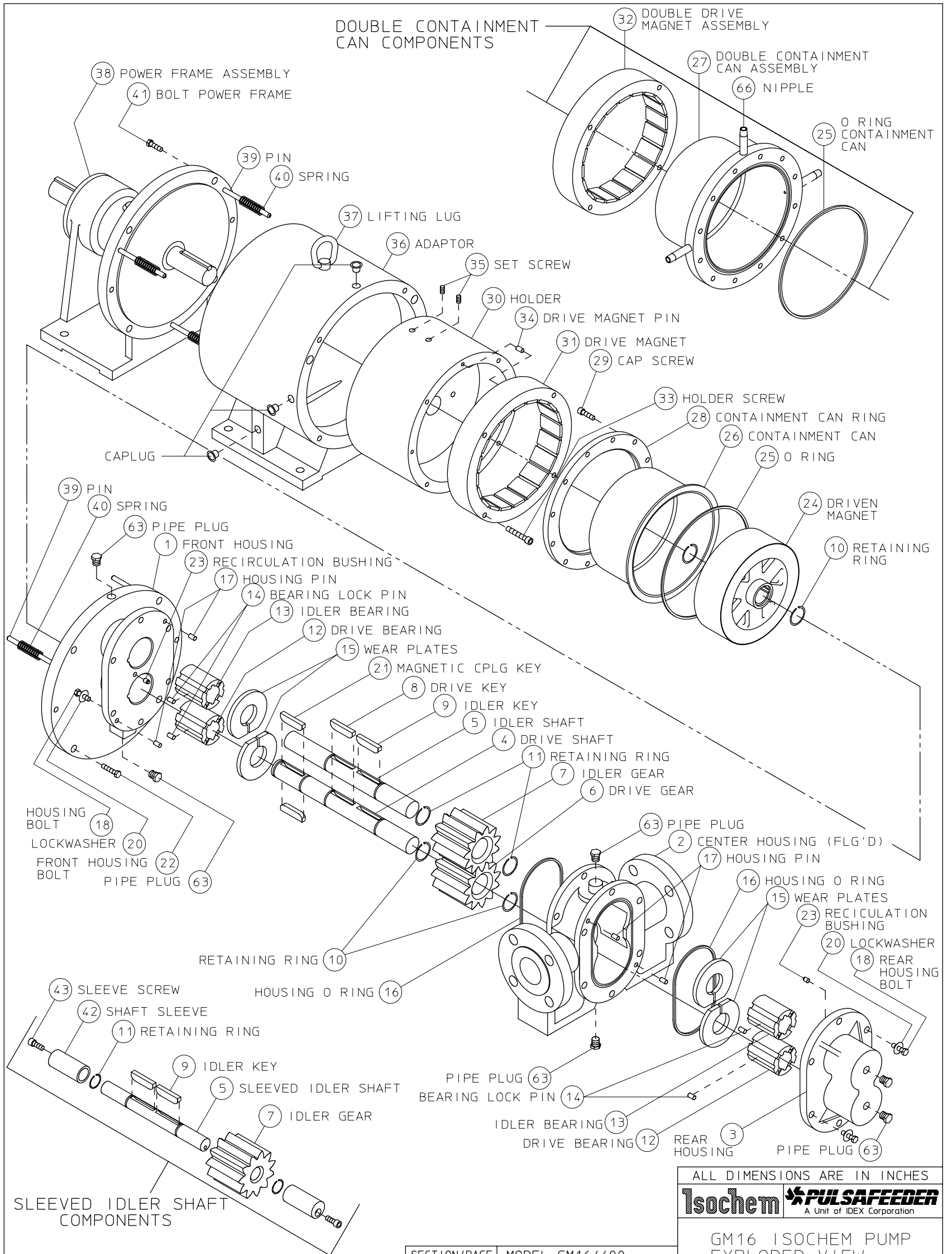

ALL DIMENSIONS ARE IN INCHES
Isochem **PULSAFEEDER**
 A Unit of IDEX Corporation

GM16 ISOCHEM PUMP
 EXPLODED VIEW

SECTION/PAGE	MODEL GM16/400
EFFECTIVE	04/04/94
SUPERSEDES	NEW

DWN BY: CLA	SD-2781
DATE: 04/04/94	

REF	REVISION UPDATE	DATE

ITEM CLASS GM16 = IU
 PRODUCT LINE = H / ISOCHEM

**ISOICHEM GM16 SERIES PUMP
 CONSOLIDATED B / M**

SECTION: MODEL GM16
 PAGE: 200
 DATE REV.: 11 / 12 / 12
 SUPERSEDES: 02 / 23 / 10

STRUCTURED WITH NO DASHES
 EXAMPLE: GM16XXXXXX

STANDARD PUMP MATERIAL		
316 SS (U)	ALLOY C (V)	ALLOY 20 (W)
PART NUMBER	MATERIAL	PART NUMBER

DESCRIPTION	QTY	PART NUMBER	MATERIAL	PART NUMBER	MATERIAL	PART NUMBER	MATERIAL	ITEM
-------------	-----	-------------	----------	-------------	----------	-------------	----------	------

POSITION 3 STANDARD PUMP - NON-VARIABLE COMPONENTS

HOUSING, FRONT	1	99609	316 SS	99610	ALLOY C	99611	ALLOY 20	1
HOUSING, CENTER 2.00-150# FLG	1	90020	316 SS	90021	ALLOY C	90022	ALLOY 20	2
HOUSING, REAR	1	90201	316 SS	90205	ALLOY C	90204	ALLOY 20	3
# RING, RETAINING 1"	4-6	96702	316 SS	96708	ALLOY C	96708	ALLOY C	10, 11
# RING, RETAINING 3/4"	0-2	96701	316 SS	96709	ALLOY C	96709	ALLOY C	11
# KEY, MTL DRIVE/IDLER GEAR 1"	*2	91904	316 SS	91910	ALLOY C	91910	ALLOY C	8, 9
# KEY, MTL IDLER GEAR 1"	*0-2	91904	316 SS	91910	ALLOY C	91910	ALLOY C	8, 9
# KEY, CBN/PLSTC GEAR 3/4"	0-2	91929	ALLOY C	91929	ALLOY C	91929	ALLOY C	9
# KEY, MAGNETIC CPLG - DRIVEN	*2	91904	316 SS	91910	ALLOY C	91910	ALLOY C	21
# PIN, BEARING LOCK	*4	90801	316 SS	90803	ALLOY C	90803	ALLOY C	14
# BUSHING, RECIRCULATION (.000)	1	99618-00	TFE	99618-00	TFE	99618-00	TFE	23
# O-RING, HOUSING	2	91101	TFE	91101	TFE	91101	TFE	16
PIN, HOUSING	*4	90801	316 SS	90801	316 SS	90801	316 SS	17
BOLT, HOUSING	12	W770412-188	188 SS	W770412-188	188 SS	W770412-188	188 SS	18
LOCKWASHER, HOUSING	12	W771107-188	188 SS	W771107-188	188 SS	W771107-188	188 SS	20
PLUG, 1/4" NPT	6	16415	316 SS	16422	ALLOY C	16432	ALLOY 20	63
NAMEPLATE	1	41210	188 SS	41210	188 SS	41210	188 SS	--

POSITION 9, 10, AND 11 OPTIONS - DELETE CORRESPONDING STANDARD PUMP COMPONENT FROM B/M

B	# O-RING, HOUSING	2	91106	SS / PFA	91106	SS / PFA	91106	SS / PFA	16
	# O-RING, CONTAINMENT CAN	1-2	W212172-001	SS / PFA	W212172-001	SS / PFA	W212172-001	SS / PFA	25
	HOUSING, REAR - RECIRCULATION	1	90201-3	316 SS	90205-3	ALLOY C	90204-3	ALLOY 20	3
	# BUSHING, RECIRCULATION (.060)	2	99618-06	TFE	99618-06	TFE	99618-06	TFE	23
R	# WEAR PLATE, RECIRCULATION	4	90516	CARBON	90516	CARBON	90516	CARBON	15
	# WEAR PLATE, RECIRCULATION		90517	TFE (GF)	90517	TFE (GF)	90517	TFE (GF)	15
	# WEAR PLATE, RECIRCULATION		90518	CERAMIC	90518	CERAMIC	90518	CERAMIC	15
	# WEAR PLATE, RECIRCULATION		90519	PEEK	90519	PEEK	90519	PEEK	15
W	DRIVEN MAGNET ASSY (WELDED)	1	99666	316 SS	99667	ALLOY C	99668	ALLOY 20	24
HF	# IDLER SHAFT, 1" DIA	1	NG070021-316	316 SS	----	----	----	----	--
	# GEAR, IDLER, 1" DIA	1	NG010026-PK1	316 SS	----	----	----	----	--
	# BEARING, SLTD DRV/IDL SHAFT, 1"	4	90437	EWCBN	----	----	----	----	--

*COMPONENT QUANTITY MAY BE CUMULATIVE OVER ENTIRE B / M
 # DENOTES RECOMMENDED SPARE PART

DWG: GM16P200

ISOCHEM GM16 SERIES PUMP CONSOLIDATED B / M

SECTION: MODEL GM16
PAGE: 201
DATE REV.: 10 / 17 / 14
SUPERSEDES: 11 / 12 / 12

STANDARD PUMP MATERIAL		
316 SS (U)	ALLOY C (V)	ALLOY 20 (W)

DESCRIPTION	QTY	PART NUMBER	MATERIAL	PART NUMBER	MATERIAL	PART NUMBER	MATERIAL	ITEM
-------------	-----	-------------	----------	-------------	----------	-------------	----------	------

POSITION 4 & 5 DRIVE AND IDLER GEAR MATERIAL

A	# GEAR, DRIVE/IDLER	1"	1-2	90668	316 SS	----	----	----	----	6, 7
C	# GEAR, DRIVE/IDLER	1"	1-2	90667	ALLOY C	90667	ALLOY C	90667	ALLOY C	6, 7
K	# GEAR, IDLER	3/4"	0-1	90676	CARBON	90676	CARBON	90676	CARBON	7
T	# GEAR, IDLER	3/4"		90670	TFE (GF)	90670	TFE (GF)	90670	TFE (GF)	7
E	# GEAR, IDLER	3/4"		90678	PEEK	90678	PEEK	90678	PEEK	7

POSITION 6 WEAR PLATE MATERIAL

K	# WEAR PLATE, SLOTTED		4	90503	CARBON	90503	CARBON	90503	CARBON	15
T	# WEAR PLATE, SLOTTED			90510	TFE (GF)	90510	TFE (GF)	90510	TFE (GF)	15
Z	# WEAR PLATE, SLOTTED			90512	CERAMIC	90512	CERAMIC	90512	CERAMIC	15
E	# WEAR PLATE, SLOTTED			90515	PEEK	90515	PEEK	90515	PEEK	15

POSITION 7 SHAFT AND BEARING MATERIAL

STANDARD CONSTRUCTION

L	# BEARING, DRIVE/IDLER SHAFT	1"	4	90437	EWCBN	90437	EWCBN	90437	EWCBN	12, 13
	# SHAFT, DRIVE		1	90379	316 SS	90380	ALLOY C	90381	ALLOY 20	4
	# SHAFT, IDLER (METAL GEAR)	1"	1	90349	316 SS	90351	ALLOY C	90350	ALLOY 20	5
	IDLER SHAFT ASSEMBLY	3/4"		----	----	----	----	----	----	--
	SHAFT, SLEEVED IDLER		1	99672	316 SS	99673	ALLOY C	99674	ALLOY 20	5
	# SLEEVE, SHAFT	1"	2	90391	316 SS	90392	ALLOY C	90393	ALLOY 20	42
# SCREW, SLEEVE		2	W770021-316	316 SS	W770021-HCO	ALLOY C	W770021-020	ALLOY 20	43	
T	# BEARING, DRIVE/IDLER SHAFT	1"	4	90428	TFE (GF)	90428	TFE (GF)	90428	TFE (GF)	12, 13
	# SHAFT, DRIVE		1	90379	316 SS	90380	ALLOY C	90381	ALLOY 20	4
	# SHAFT, IDLER (METAL GEAR)	1"	1	90349	316 SS	90351	ALLOY C	90350	ALLOY 20	5
	IDLER SHAFT ASSEMBLY	3/4"		----	----	----	----	----	----	--
	SHAFT, SLEEVED IDLER		1	99672	316 SS	99673	ALLOY C	99674	ALLOY 20	5
	# SLEEVE, SHAFT	1"	2	90391	316 SS	90392	ALLOY C	90393	ALLOY 20	42
# SCREW, SLEEVE		2	W770021-316	316 SS	W770021-HCO	ALLOY C	W770021-020	ALLOY 20	43	
4	# BEARING, SLTD DRV/IDL	1"	4	90441	EWCBN	90441	EWCBN	90441	EWCBN	12, 13
	# SHAFT, DRIVE		1	90379	316 SS	90380	ALLOY C	90381	ALLOY 20	4
	# SHAFT, IDLER (METAL GEAR)	1"	1	90349	316 SS	90351	ALLOY C	90350	ALLOY 20	5
	IDLER SHAFT ASSEMBLY	3/4"		----	----	----	----	----	----	--
	SHAFT, SLEEVED IDLER		1	99672	316 SS	99673	ALLOY C	99674	ALLOY 20	5
	# SLEEVE, SHAFT	1"	2	90391	316 SS	90392	ALLOY C	90393	ALLOY 20	42
# SCREW, SLEEVE		2	W770021-316	316 SS	W770021-HCO	ALLOY C	W770021-020	ALLOY 20	43	

EXTENDED/WEAR - BOTH SHAFTS

C	# BEARING, DRIVE/IDLER SHAFT	1"	4	90437	EWCBN	90437	EWCBN	90437	EWCBN	12, 13
	# SHAFT, DRIVE		1	90382	CW / 316 SS	90383	CW / ALY C	90384	CW / ALY20	4
	# SHAFT, IDLER (METAL GEAR)	1"	1	90385	CW / 316 SS	90386	CW / ALY C	90387	CW / ALY20	5
	IDLER SHAFT ASSEMBLY	3/4"		----	----	----	----	----	----	--
	SHAFT, SLEEVED IDLER		1	99672	316 SS	99673	ALLOY C	99674	ALLOY 20	5
	# SLEEVE, SHAFT	1"	2	90394	CW / 316 SS	90395	CW / ALY C	90396	CW / ALY20	42
# SCREW, SLEEVE		2	W770021-316	316 SS	W770021-HCO	ALLOY C	W770021-020	ALLOY 20	43	

CORROSION/WEAR ("CW") - BOTH SHAFTS

B	# BEARING, DRIVE/IDLER SHAFT	1"	4	90439	SICBD	90439	SICBD	90439	SICBD	12, 13
	# SHAFT, DRIVE		1	90382	CW / 316 SS	90383	CW / ALY C	90384	CW / ALY20	4
	# SHAFT, IDLER (METAL GEAR)	1"	1	90385	CW / 316 SS	90386	CW / ALY C	90387	CW / ALY20	5
	IDLER SHAFT ASSEMBLY	3/4"		----	----	----	----	----	----	--
	SHAFT, SLEEVED IDLER		1	99672	316 SS	99673	ALLOY C	99674	ALLOY 20	5
	# SLEEVE, SHAFT	1"	2	90394	CW / 316 SS	90395	CW / ALY C	90396	CW / ALY20	42
# SCREW, SLEEVE		2	W770021-316	316 SS	W770021-HCO	ALLOY C	W770021-020	ALLOY 20	43	

*COMPONENT QUANTITY MAY BE CUMULATIVE OVER ENTIRE B / M

DWG: GM16P201

DENOTES RECOMMENDED SPARE PART

ISOCHEM GM16 SERIES PUMP CONSOLIDATED B / M

SECTION: MODEL GM16
PAGE: 202
DATE REV.: 11 / 12 / 12
SUPERSEDES: 04 / 01 / 98

STANDARD PUMP MATERIAL		
316 SS (U)	ALLOY C (V)	ALLOY 20 (W)

DESCRIPTION	QTY	PART NUMBER	MATERIAL	PART NUMBER	MATERIAL	PART NUMBER	MATERIAL	ITEM
-------------	-----	-------------	----------	-------------	----------	-------------	----------	------

POSITION 8 MAGNETIC COUPLING COMPONENTS

COMMON PARTS	DRIVEN MAGNET ASSY	1	99651	316 SS	99652	ALLOY C	99653	ALLOY 20	24
	BOLT, FRONT HOUSING/ADAPTOR	*4	W770426-188	188 SS	W770426-188	188 SS	W770426-188	188 SS	22
	# O-RING, CONTAINMENT CAN	*1	W212172-TFE	TFE	W212172-TFE	TFE	W212172-TFE	TFE	25
	SCREW, SET	2	W771004-030	STL	W771004-030	STL	W771004-030	STL	35
	PIN, DRIVE MAGNET/HOLDER	4	W771209-003	STL	W771209-003	STL	W771209-003	STL	34
	SCREW, SKHD DRIVE MAGNET/HOLDER	4	W770027-188	188 SS	W770027-188	188 SS	W770027-188	188 SS	33
	CAN, CONTAINMENT	1	99600	ALLOY C	99600	ALLOY C	99600	ALLOY C	26
	SCREW, CONTAINMENT CAN RING	12	W770021-188	188 SS	W770021-188	188 SS	W770021-188	188 SS	29
	HOLDER, DRIVE MAGNET	1	99640	STL	99640	STL	99640	STL	30
	ADAPTOR, POWERFRAME	1	99619	ALU	99619	ALU	99619	ALU	36
	LUG, LIFTING	1	W212304-STL	STL	W212304-STL	STL	W212304-STL	STL	37
	PIN	6	99641	188 SS	99641	188 SS	99641	188 SS	39
	SPRING	6	99642	188 SS	99642	188 SS	99642	188 SS	40
BOLT, POWERFRAME ADAPTOR	*4	W770426-188	188 SS	W770426-188	188 SS	W770426-188	188 SS	41	

STANDARD U.S. MOUNTING

SINGLE CONTAINMENT CAN COMPONENTS

R	POWERFRAME μ 1.125 INPUT SHAFT	1	99648	STL	99648	STL	99648	STL	38
	DRIVE MAGNET ASSY	1	99636	STL	99636	STL	99636	STL	31
	RING, CONTAINMENT CAN	1	99630	316 SS	99630	316 SS	99630	316 SS	28

DOUBLE CONTAINMENT CAN COMPONENTS

T	POWERFRAME μ 1.125 INPUT SHAFT	1	99648	STL	99648	STL	99648	STL	38
	DRIVE MAGNET ASSY	1	99639	STL	99639	STL	99639	STL	32
	CAN ASSY, CONTAINMENT	1	99631	316 SS	99632	ALLOY C	99633	ALLOY 20	27
	# O RING, CONTAINMENT CAN ASSY	*1	W212172-TFE	TFE	W212172-TFE	TFE	W212172-TFE	TFE	25
	NIPPLE, 1/8" NPT X 2.00	2	W773965-208	316 SS	W773965-235	ALLOY C	W773965-020	ALLOY 20	66

STANDARD METRIC MOUNTING

SINGLE CONTAINMENT CAN COMPONENTS

U	POWERFRAME μ 28 MM INPUT SHAFT	1	99649	STL	99649	STL	99649	STL	38
	DRIVE MAGNET ASSY	1	99636	STL	99636	STL	99636	STL	31
	RING, CONTAINMENT CAN	1	99630	316 SS	99630	316 SS	99630	316 SS	28

DOUBLE CONTAINMENT CAN COMPONENTS

V	POWERFRAME μ 24 MM INPUT SHAFT	1	99649	STL	99649	STL	99649	STL	38
	DRIVE MAGNET ASSY	1	99639	STL	99639	STL	99639	STL	32
	CAN ASSY, CONTAINMENT	1	99631	316 SS	99632	ALLOY C	99633	ALLOY 20	27
	# O RING, CONTAINMENT CAN ASSY	*1	W212172-TFE	TFE	W212172-TFE	TFE	W212172-TFE	TFE	25
	NIPPLE, 1/8" NPT X 2.00	2	W773965-208	316 SS	W773965-235	ALLOY C	W773965-145	ALLOY 20	66

*COMPONENT QUANTITY MAY BE CUMULATIVE OVER ENTIRE B / M

DWG: GM16P202

DENOTES RECOMMENDED SPARE PART